



26 November 2025

We're building a new footpath and pram crossings on Shelly Bay Road, Beachlands

Kia ora,

We are building a new footpath and pram crossings to improve journeys for pedestrians on Shelly Bay Road, Beachlands. Work will take place between 1 December to 14 December 2025, Monday to Friday, from 7am to 7pm.

To check for updates on this work please search

'Franklin Paths Programme moves to delivery' or scan the QR code.



Factors such as wet weather could mean a delayed start. If the delay is significant, we will notify you.

Here is what you need to know about the work happening near you:

Where	<ul style="list-style-type: none"> Shelly Bay Road, Beachlands (see work location map below)
When	<ul style="list-style-type: none"> 1 December to 14 December 2025 (Monday to Friday) from 7am to 7pm
What we're doing	<ul style="list-style-type: none"> Construction of a new footpath on the western side of Shelly Bay Road Installation of new pram crossings on the intersection of Karaka Road
How it may impact you	<ul style="list-style-type: none"> On-street parking will be limited during works. You may need to either park on your property or on a side road and walk to your property. Works will create noise and vibration; we'll do our best to keep noise levels down.
How travel is affected	<ul style="list-style-type: none"> Lanes on Shelly Bay Road will be reduced Detours will be in place to redirect traffic around the work site (see detour map(s) below). <p>Traffic controllers will be on site to assist around the work site. Please follow all signs, light signals and traffic directions.</p>

Work location

The map below shows where the work is taking place:



Detour maps

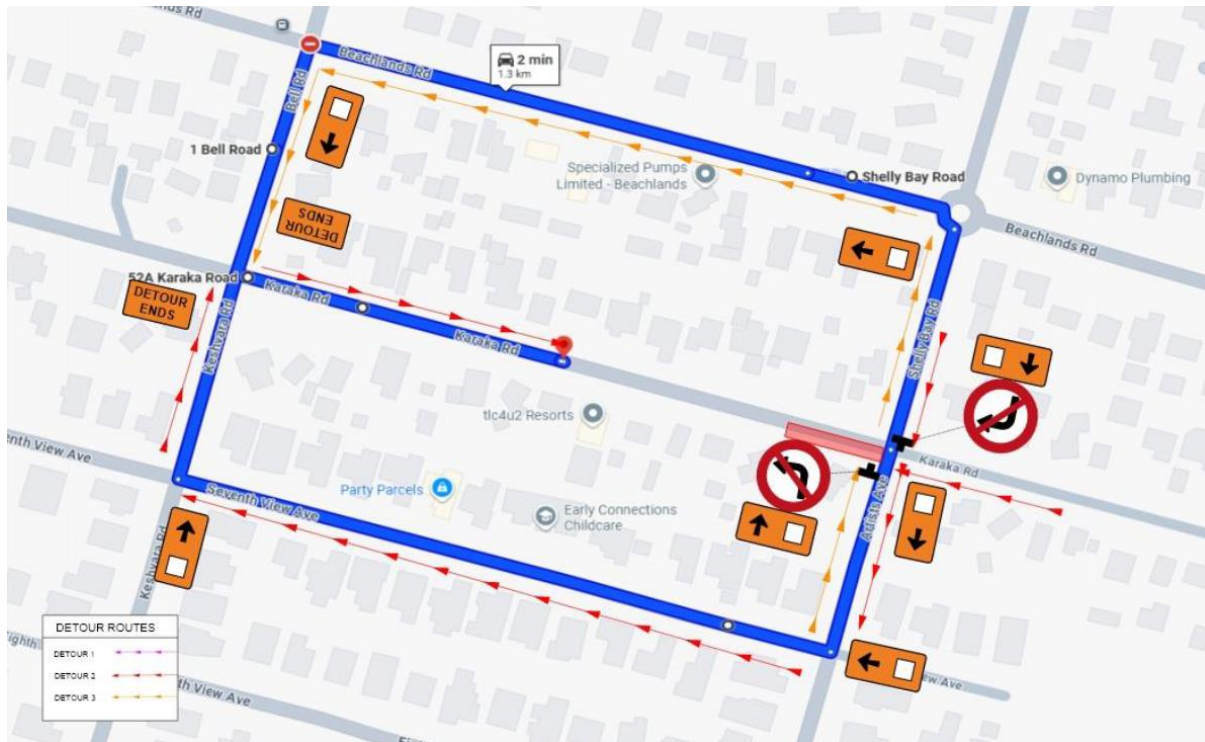

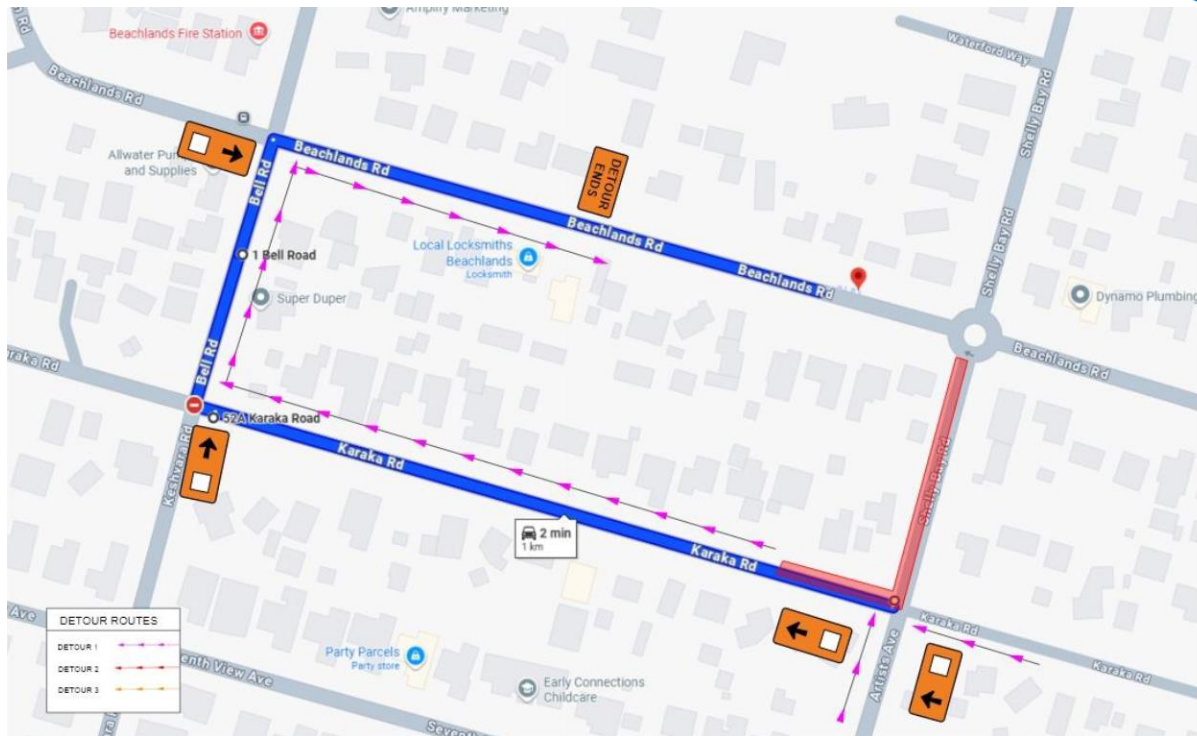

Contact us

If you have any queries or concerns about this project, please contact AT:

Email: info@at.govt.nz (Include reference: Shelly Bay Road)

Phone: 09 355 3553

If you have any queries related to the **construction**, please contact:

Name: Arnel Agor

Phone: 0212230678

Thank you for your understanding and co-operation while we carry out this work.

Ngā mihi,

Auckland Transport